

**Morval Road, Brixton, SW2**

**£450,000**

2 bedroom flat - conversion for sale

## Property Details

The flat is beautifully designed and has been cared for tentatively by the current owners, with fresh and neutral décor throughout plus high quality kitchen and bathroom finishes. Two well-proportioned double bedrooms occupy one side of the flat, the larger flooded with light through a characterful bay window and complete with an en-suite shower room, the other peacefully overlooking the gardens to the rear. A second, family-sized bathroom separates the bedrooms from the living space. A large open room, dual-aspect natural lighting and a modern, sleek kitchen add to the appealing atmosphere where there is space to cook, entertain, dine and relax very comfortably. The property is an ideal pied-à-terre, buy-to-let or to share with friends.

## Features

- Two double bedrooms
- Two bathrooms
- Double fronted Victorian conversion
- Bright and airy throughout
- Ideal residential location
- Under 10 minutes to central Brixton

Council tax band C

EPC rating C (73)





Morval Road, Brixton, SW2



## 2 Bedroom Flat

Approx internal area:

**570 sqft 53 sqm**

While we do try our very best, floor plans are produced as a guide only and we take no responsibility for the precise accuracy with which any property is represented

# Morval Road

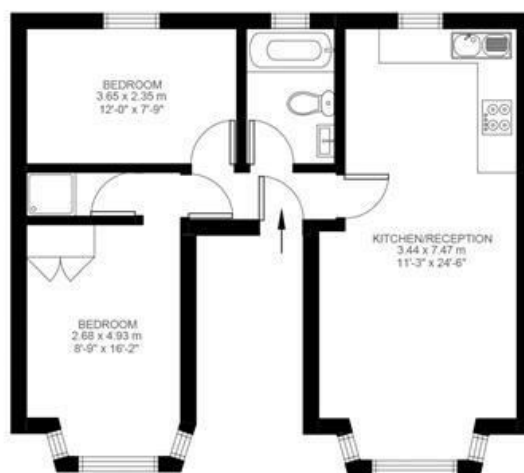

First Floor



Morval Road, Brixton, SW2

